



# Trumpet Corporate Park I

Zion, Illinois • 150,000 square feet

# For Sale or Lease

# Trumpet Corporate Park I

## Location Map



## Park Map

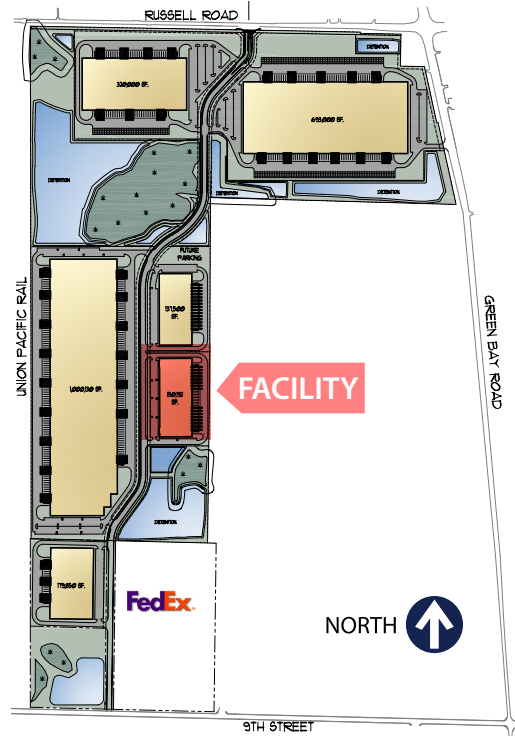

## Facility Plan

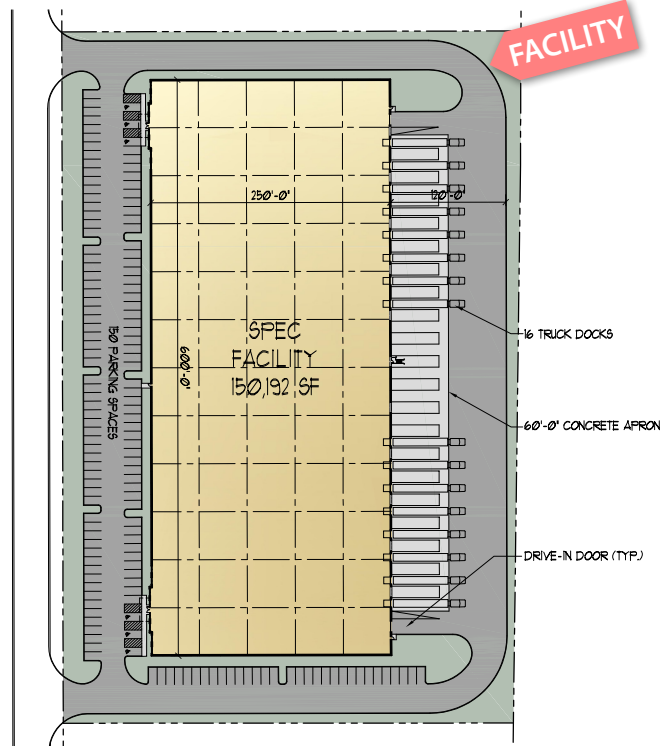

## For Sale or Lease

building size:	150,000 SF (divisible)
expandability:	to 300,000 SF
office:	To Suit
site size:	8 acres
description:	Pre-cast
ceiling height:	30' Clear
parking:	150 cars, 25 trailers
loading:	16 exterior truck docks, 2 drive-in doors
bay size:	50' x 50'
power:	1200 amps
heat:	Positive Pressure Rooftop units
sprinklers:	ESFR
lease rate:	\$4.75 PSF net

## For more info

**Rick Delisle**  
847-812-8180  
rdelisle@lee-associates.com  
Leasing & Sales

**Mike Prost**  
847-208-5400  
mprost@lee-associates.com

Owner/Developer